



Gold Standard Brushless Loader

The GSL Series Loader is standard with a brushless motor, pendant control and pivot access.

As brushes wear, the commutator wears creating an increasing gap where dust contamination and motor failure occurs. These factors cause brushes to wear down faster and faster with each change, leading to added maintenance and downtime. Motor manufacturers recommend discarding vacuum loader motors after three brush sets.

› **Maintenance-free Brushless Motors Last Four Times As Long As Motors With Brushes**

Long-life motor and no brush changes eliminate maintenance and downtime.

› **Double Pivot Access**

Loader operates in upright position then pivots and locks in place for easy access.

Patent # 8,753,432 and 8,070,844

Plus

- › 115V/1ph/50-60 Hz operation
- › 15 foot (4.6 meters) length of flex hose, lance and hose clamps
- › Dual reinforced polyester disc filter media
- › All material contact points are non-ferrous
- › Dump valve with integrated demand level switch on standard models
- › Conveying rate up to 1000 lb/hr
- › Five-year warranty

› **Full-featured, Standard Plug-In Pendant Control**

Full-featured control is mounted on the loader. A 12-foot cable (standard) puts control at your fingertips, so changing loader parameters is easy.

› **MicroBurst Keeps Filters Clean**

High intensity MicroBurst blowback air blasts the whole filter area to remove dust and fines, ensuring that the dump throat is clear for proper sealing.

› **SureSeal Flapper Valve Avoids Loading Failures**

Reliable SureSeal seal surfaces stay aligned and resist wear, while a MicroBurst air blast removes residual dust for a tight seal.



GSL-12

GSL-19



Remote pendant control

Brushless Vacuum Motor lasts 4x's longer with no brush changes!

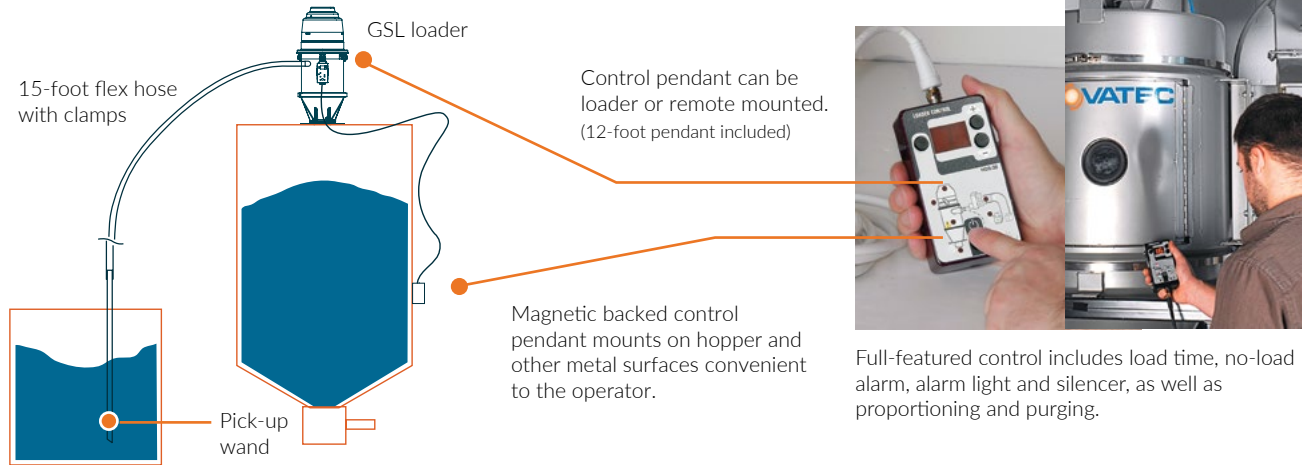
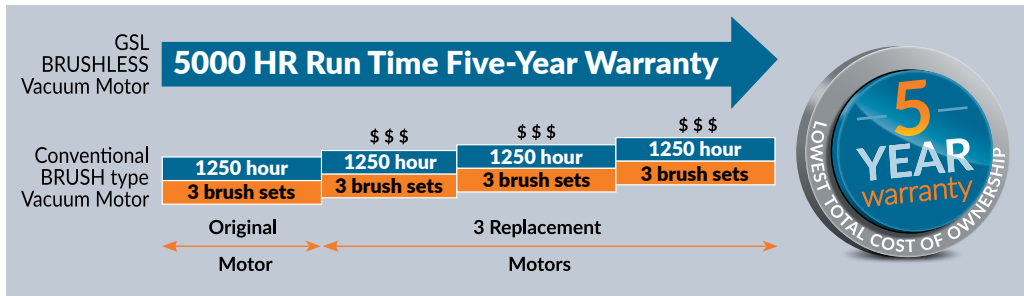

Upright Operating Position



Pivot Position Clean Out is Quick and Easy



Easy pivot access for clean out.



Loader pivots forward from operating position and a captive detent pin locks loader in place during operation. Lid pivots back and locks in place for easy access.

Tool-less, Lockable Pivot Position Access



SPECIFICATIONS

GSL-12

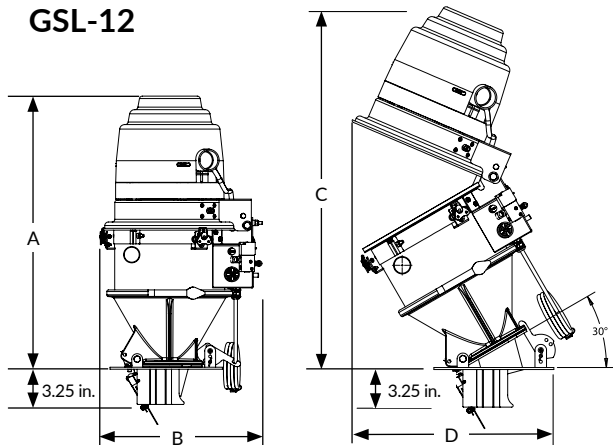

GSL-19

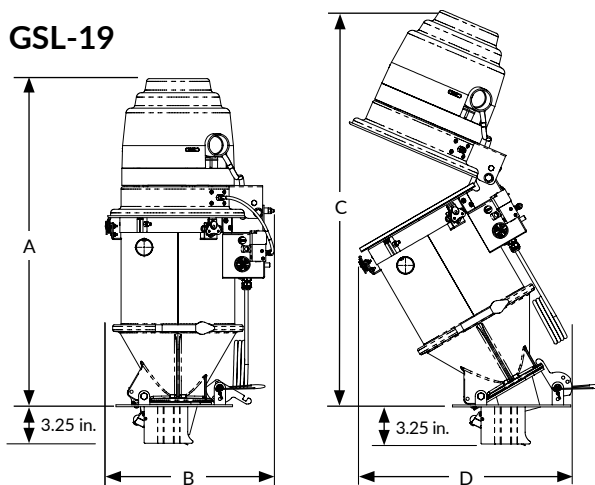

Model	Capacity*	Inlet O.D.	Discharge Diameter	A	B	C	D
GSL-12	12 lb	1.5 in.	3 in.	25.20 in.	15.03 in.	31.38 in.	17.44 in.
GSL-19	19 lb	1.5 in.	3 in.	29.20 in.	14.95 in.	34.77 in.	19.40 in.

*Based on PC pellets @ 38 lb/ft³

Pivoting and opening top requires 6 in. (15.2 cm) for clearance on GSL-19.

Recommended throughput: GSL-19 = up to 1000 lb/hr (450 kg/hr) GSL-12 = up to 650 lb/hr (295 kg/hr) based on free flowing virgin pellets through 15 feet of flex hose.

Exceeding recommended throughputs may result in shortened motor and filter life; however, increased throughputs are possible depending on resin and equivalent feet calculation. Generally, a central conveying system should be used for higher throughputs.

Maximum conveying distance in addition to 15 feet of hose, can include 30 feet of horizontal tubing and one elbow. Additional vertical travel, bends or flex hose will reduce recommended throughput.

Mounting Flexibility

Standard mounting hole pattern plus adapter ring allows GSL to replace any Novatec loader as well as competitive models.

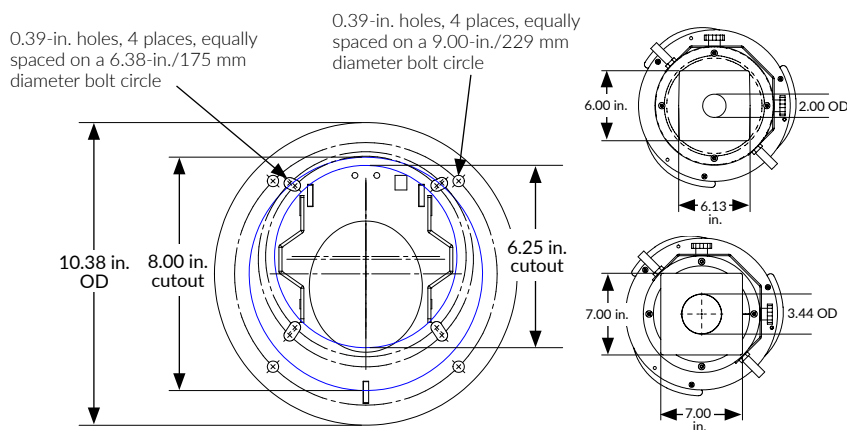

Mounting Patterns



Machine mount flange dimensions
6 inch x 6 inch

Machine Mount Glass for GSLs

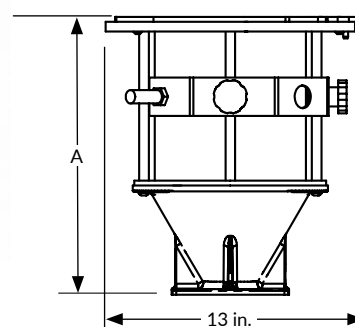

Config	Machine Mount Assy P/N*	A (in.)
8 lb	GMM-GSL-8	14.47
12 lb	GMM-GSL-12	18.47
16 lb	GMM-GSL-16	22.47

* Order separately. Must be assembled in field.

OPTIONS

- **2-inch inlet**
In lieu of the standard 1.5-inch inlet.
- **Extended Wear Package**
Recommended when loading abrasive materials - contact factory.
- **Alternate Glass Size**
12 lb glass (adds 4 in to height) or 16 lb glass (adds 7 in. to height).
- **Retrofit Kit to convert GSLs into machine mount models**
Kit includes glass, twist-lock plug and photo-eye alternate mounting flange (7 in. x 7 in. with 3.5 in. opening) removes 1.5 in. from height.

ACCESSORIES

- **Replacement Plug-N-Play Control Pendant with 12 ft cable**
One included with each GSL.
- **Replacement 12 ft cable**
- **External Proportioning Valve**
Includes coupler, wand, hose and clamps. 1.5 in. and 2.0 in. O.D.
- **Level Switch, Capacitance, 30 mm dia., 2 m cable**
- **Capacitance Level Switch in lieu of Photo-eye Sensor**
For GSL-MM models.