

# Central Drying Assemblies

CDA2 series central drying assemblies are used to custom-dry different resins in varying quantities and now include OverDry protection as standard.

A central drying system provides desiccated air to multiple units to custom-dry several resins in varying quantities. Each CDA2 includes a stand-mounted insulated hopper equipped with a heater/blower unit.

**5**  
YEAR  
warranty



CDA2-400

## Assembled Complete for Easy Installation

Each CDA2 includes a hopper on a stand with 24" clearance, a heater/blower and control package to assure balanced system airflow.

## Uniformly Sized Stand Assemblies

8" Process and return headers and 3" dry air purge headers, are at uniform heights, ready to be connected side-by-side with other CDA2 units.

## Well-Equipped Insulated Hoppers

Complete with a slide-gate shut-off, slide-gate drain port, return air pellet screen, large door and sight glass are provided for material level monitoring and easy clean out.

## Standard OverDry Protection Built Into Each CDA2

Ensures that moisture sensitive materials, like nylons, are not over dried while providing energy saving as well.

## 5-Year Warranty

For lowest cost of ownership.

## Process Temperature up to 350°F (177°C)

Proper drying temperature for any material.

## Control From Central Dryer

Optional central dryer control module kit provides control for up to 16 CDA2 units.

FlexXpand NovaNet option provides control of up to 4 central dryers and 48 CDA2's.

(See central drying and FlexXpand / NovaNet data sheets)

### Plus

- › Main line disconnect switch
- › Branch circuit protection
- › Low airflow switch
- › Inlet/outlet dampers
- › Lid bolt hole pattern for Novatec loader or receiver
- › Solid state contactor and mechanical safety on booster blower and heater
- › 5-Year warranty

# Central Drying Systems

— 5 —  
YEAR  
warranty



Elongated sight glass  
in each hopper

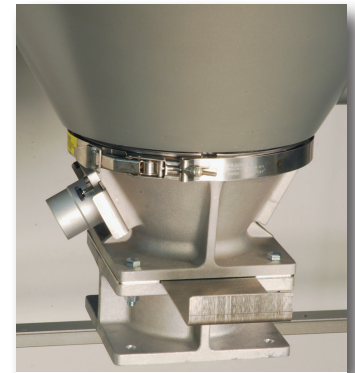

Slide gate discharge valve  
and drain port

A single central dryer supplies  $-40^{\circ}$  dew point air to multiple central drying assemblies. Heater/blower units at each hopper provide custom-heated air to dry multiple materials.

# Reduce energy usage and **save space!**



Inlet/outlet dampers control air flow to each hopper



Modular design enables easy installation



Control locally at CDA2 or from dryer control



Heater/blower control with standard OverDry protection

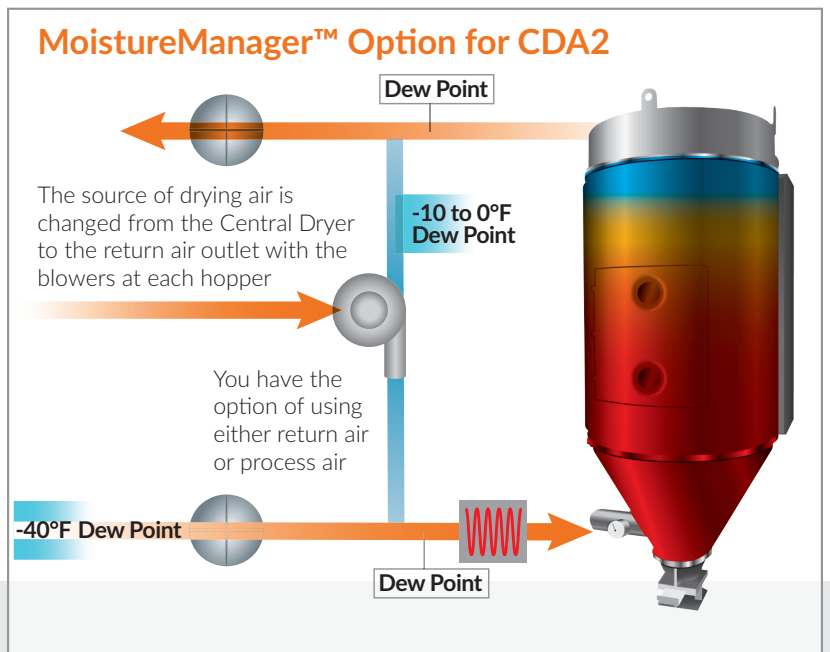

MoistureManager dew point control optional – often used in conjunction with OverDry protection for maximum drying control.

## Specifications:

MODEL	Hopper size				Dimensions						**HB2 MODEL
	*By weight		By volume		W		D		H		
	lb	Kg	ft <sup>3</sup>	Liters	in	cm	in	cm	in	cm	
CDA2-60	60	27	1.5	42.5	40	100	49	125	78	198	HB2-15
CDA2-100	100	45	2.5	70.8	40	100	49	125	78	198	HB2-15
CDA2-150	150	68	3.9	110	40	100	49	125	84	213	HB2-40
CDA2-200	200	90	5	142	50	127	49	125	78	198	HB2-40
CDA2-300	300	136	7.9	224	50	127	50	120	85	216	HB2-60
CDA2-400	400	180	10	284	50	127	49	125	92	234	HB2-60
CDA2-600	600	270	15	425	60	152	49	125	98	249	HB2-100
CDA2-800	800	360	20	567	60	152	49	125	106	269	HB2-150
CDAB-1000	1000	450	25	709	60	152	49	125	109	277	HB2-150
CDA2-1500	1500	680	39.5	1082	68	172	65	165	129	328	HB2-250
CDA2-2000	2000	900	52.6	1490	76	193	65	165	134	340	HB2-300
CDA2-2500	2500	1140	65.8	1863	78	198	67	170	149	379	HB2-400
CDA2-3000	3000	1361	79	2237	96	244	69	175	154	391	HB2-600
CDA2-4000	4000	1814	105.2	2980	96	244	75	191	178	452	HB2-750

\*Based on polycarbonate pellets @ 38 lb/ft<sup>3</sup>

\*\*Standard voltage: 460/3/60

Note: 60 through 150 lb hoppers are stainless steel; all others are carbon steel.

### Accessories:

#### Manifold end loop kit:

(Includes U-duct with damper and couplers)

### Options:

#### Dew point indication

#### MoistureManager™ dewpoint control:

Add-MM after model number

#### Control from central dryer:

Provides gateway Control of up to 12 CDA2 hoppers from central drying control

#### Voltage options in lieu of 460/3/60:

(Show as separate line item on order).

415/3/50 VAC (no charge) 575/3/60 VAC (See price list #121)

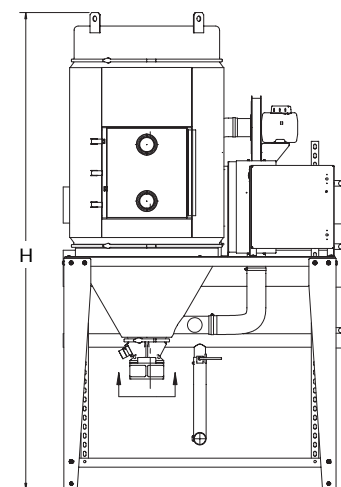
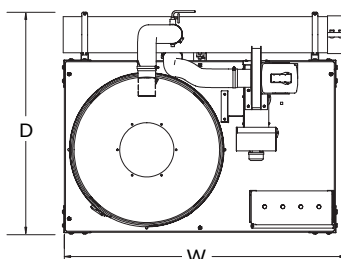

For CDA2-60 through CDA2-1200  
(Bolted frame construction)

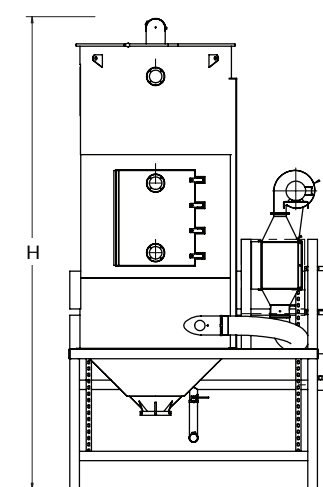
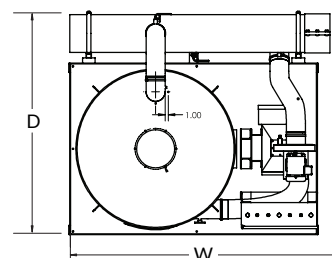

For CDA2-1500 through CDA2-4000  
(Welded frame construction available  
in all sizes upon request)