



# Conveying Accessories

Proportioning/Purge Valves: 1.5 -4" (40-100 mm)  
 External Line Valves: 1.5 -4" (40-100 mm)  
 External Fill Valves, Remote (1.5"-3" (40-75 mm)  
 Station T Valves: 1.5 -4" (40-100mm)  
 Lances: 1.5-4" (40-100mm)

Add these line valves to provide proportioning and material layering capability to vacuum loaders and receivers or use as dry air or ambient air convey/purge valves.

Heavy duty stainless steel construction with air actuated positive steel sealing disc(s). Easy, no-tool clean out through clear side cover.

— 5 —  
**YEAR**  
 warranty

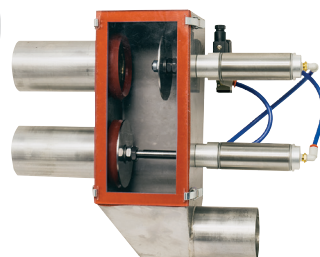

The EPV Proportioning Valve is used as a material line selector at the receiver inlet, typically to layer regrind with virgin material.

## Durable Construction

Abrasion-resistant stainless steel body with welded seams, flange-mounted high-heat silicone seals standard and stainless steel disc/seat with adjustable throw.

## Easy-View of Interior

Through thick, full sized vertical polycarbonate window.

## Easy Access

Quick-release latches allow access to interior.

## High Temperature Applications

For use with all thermoplastic resins at temperatures up to 350° F. (170° C).

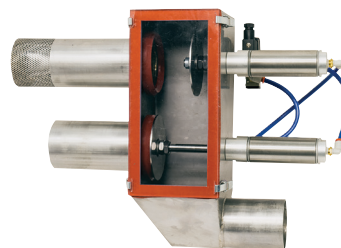

The EPV-Purge Valve is equipped with a filter screen and silicone material seal and is used for either ambient or dry air purging on material lines.

## Plus

- › Positive seal shutoff valve cylinders
- › Supplied with coupler
- › 5-Year warranty

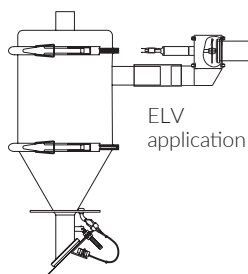

MATERIAL

ELV is used as a positive vacuum seal at the receiver inlet when not moving material, typically in common material line conveying systems. Provides in-line control of vacuum material flow. Available in 24 VDC or 115 VAC models.



Proportioning Loading Control with Blowback

## Local Proportioning Controls

Many central and self contained loading controls are equipped with proportioning and/or purging control capability for the addition of the EPV.

For control systems not equipped with proportioning, these mini PLC controls may be specified:

**PC-1-24 Proportioning Control:**  
 (for 24 VDC control systems)

**PC-1-11 Proportioning Control:**  
 (for 115 volt control systems)

## Specifications:

24 VDC Models	EPV-15-24		EPV-20-24		EPV-25-24		EPV-30-24		EPV-40-24	
115/1/60 Models	EPV-15-11		EPV-20-11		EPV-25-11		EPV-30-11		EPV-40-11	
Dimensions	in	cm	in	cm	in	cm	in	cm	in	cm
Inlet/Outlet O.D.	1.5	3.85	2	5.1	2.5	6.35	3	7.6	4	10.16
A - Height	7	17.8	8.5	21.6	11.38	28.9	11.38	28.9	14.75	37.5
B - Width	3.25	8.26	3.75	9.53	4.75	12.07	4.75	12.07	5.75	14.61
C - Length	9.94	25.25	9.94	25.25	10.69	27.15	12.25	31.1	13.19	33.5
D - Inlets C-C	2.75	7	3.25	8.26	4.19	10.64	4.19	10.64	5.25	13.34
E - Inlet Length	3.69	9.37	3.69	9.37	4.44	11.28	4.5	11.43	4.44	11.28
F - Outlet Length	3	7.62	3	7.62	3	7.62	3.5	8.89	4.5	11.4



Filter Purge Screens  
Available for all  
Sizes of EPV

Note: Compressed air consumption: 0.2 ft<sup>3</sup>/min at 80 psi (0.3 m<sup>3</sup>/hr at 5.5 bars)

**Accessories:** (Shipped separately. Show as separate line item on order.)

**Filter Purge Screen:** Enables EPV to function as an external purge valve. 1.5", 2.0", 2.5", 3.0", 4.0"

**Proportioning Valve Control:** 24VDC, 115/1/60

Note: Requires connection to 24VDC (or 115 if using 115V) power at the receiver or loader, plus load signal.

**DeviceNet Cable(s):** In lieu of standard cable(s) 24VDC

**Pneumatics Solenoid Assembly Kit:**

In lieu of Standard SMC, 24 VDC Valve

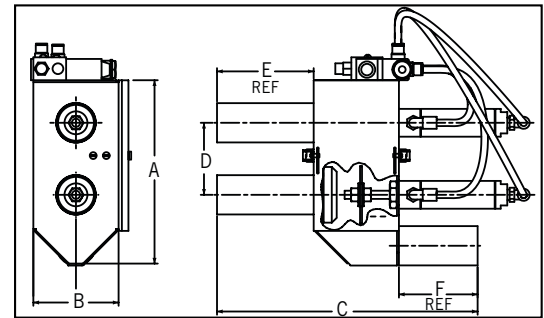

EPV Drawing

## External Proportioning Valve Application:

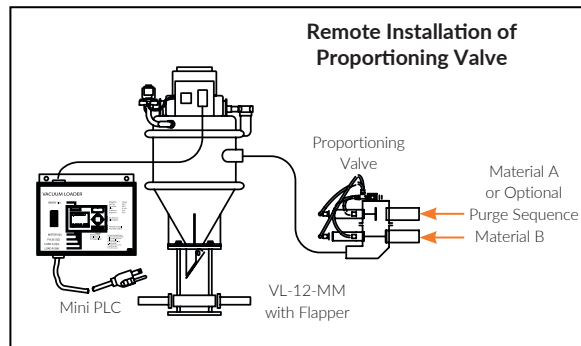
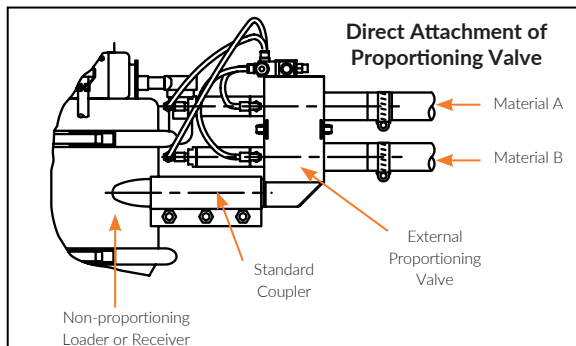

## Convey/Purge Valve Application:

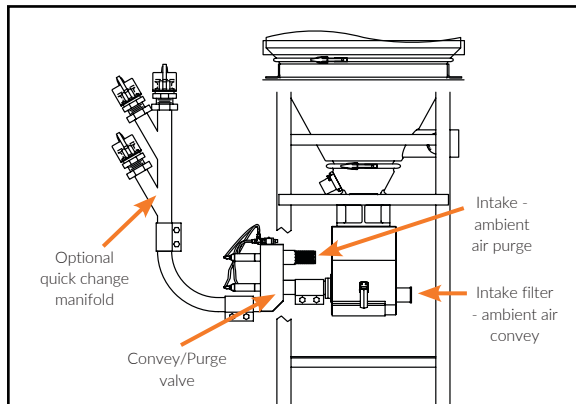

Configured to convey resin and purge material lines with ambient air.

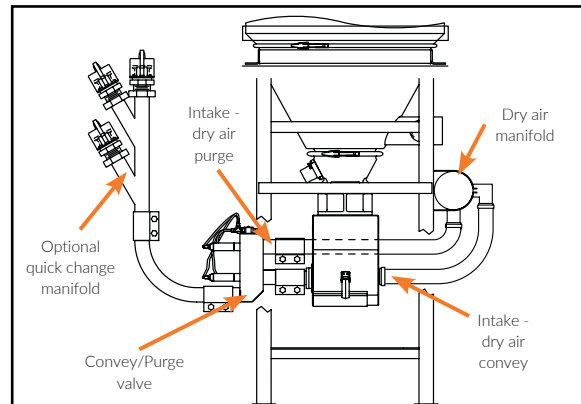

Configured to convey resin and purge material lines with dry air taken from dry air manifold.

## Station T Valves

Heavy duty aluminum construction with air-actuated positive-sealing disc. Indicator cap on shaft helps identify mal-functioning station 24. VDC or 115 VAC Models.

Inlet/Outlet Diameter in/mm	1.5/40	2.0/50	2.5/65	3.0/75	4.0/100
--------------------------------	--------	--------	--------	--------	---------

NOTE: One Station T is required for each VR Series receiver in a vacuum conveying system.



Station T Valves 1.5" to 4" O.D.

## External Fill Valves, Remote

The EFV-R Series is a stand alone valve that can be utilized with vacuum receivers that require remote-mounted fill valves (like the Station T Valve shown above). The EFV Valves can be utilized with standard VR's (vacuum receivers), VRP's (vacuum receivers for powders), and the VRH's (Vacuum Receivers with hinged lids and the "EFV Delete" option).

The EFV is not replacing the Station T valves. It is an alternative that may help in cases where the Station T's are not performing as desired.



EFV-R

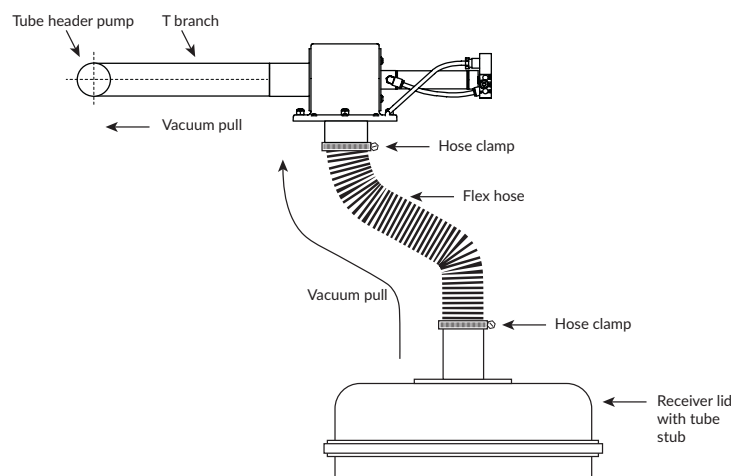

Model	Line Sizes
EFV-R1515-XX(-BB) EFV-R2020-XX(-BB) EFV-R2525-XX(-BB) EFV-R3030-XX(-BB)	For 1.5"-3" OD line sizes
EFV-R1520-XX(-BB) EFV-R2025-XX(-BB) EFV-R2530-XX(-BB) with up-sized header	For 1.5"-2.5" OD line sizes

Replace -XX with -12 for 115 VAC operation or -24 for 24 VDC operation.  
Add -BB for use with Receivers equipped with Blowback.

## Lances

Lance O.D. in/mm	1.5/40	2.0/50	2.5/65	3.0/75	4.0/100
---------------------	--------	--------	--------	--------	---------



Pick-up lance with adjustable air-flow,  
1.5" to 4" O.D.  
Available in aluminum and stainless steel..