



# SVP Vacuum Pumps

Smart Pumps with Predictive Maintenance at No Additional Cost!

## SVP Silencer Pumps operate at under 80 dBa

Provides powerful vacuum to convey free-flowing pellets, powders and regrind in single and multi-receiver systems. Smart pumps deliver maximum uptime with less maintenance, less guesswork and less hassle.

### Monitor, Diagnose and Prescribe Corrective Action with PumpSense™



### New MachineSense® App

Monitors pump components and sends maintenance advice and actionable intelligence via text and email. PumpSense™ hardware included with free access to MachineSense® data plan for 3 months.

### 3-Year Extended Pump Warranty

Included with activation and continued use of MachineSense data plan

### Lower Noise Operation

Eliminates the necessity for a sound enclosure.

### Rotary Lobe Blower, Belt Driven by a 3 Phase Motor

Creates deep vacuum for high throughput and/or long distance conveying.

### Electronic Motor Overload Protection

Phase loss detection, plus quicker trip speed vs. thermal overload provides superior motor protection.

### Starter Panel Disconnect

Circuit breaker provides local short circuit protection.



### New! E-Z Oil Drain

Easy-open valves simplify oil changes.

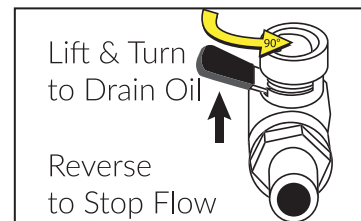

### Vacuum Breaker Valve - Standard

Provides trouble free operation and long pump life by minimizing pump starts.

### Plus

- › UL, CSA and CE compatible starter components
- › Fully enclosed belt housing
- › Vacuum gauge and relief valve
- › Standard pump voltage 460/3/60 (400V and 575V optional)
- › Standard control voltage 24 VDC (115V optional)
- › 3-Year warranty
- › \*Extended 5-year pump warranty with activation and continued use of MachineSense data plan.

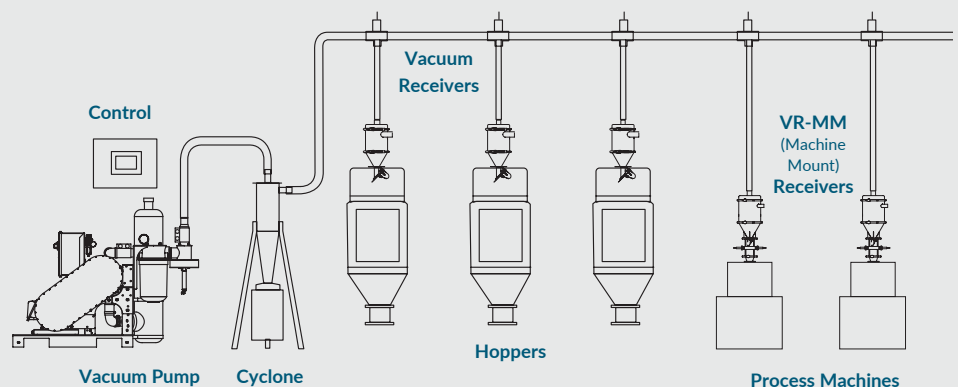

**Specifications:** (Consult factory for elevations above 3000 feet.)

Model Number	SVP-3	SVP-5	SVP-10
Pump power	3 Hp	5 Hp	10 Hp
Inlet O.D.	1.5 in	2 in	2.5 in
Air volume	55 cfm	100 cfm	170 cfm
Vacuum relief	12 Hg	12.5 Hg	12.5 Hg
Width	21.5 in	21.5 in	21.5 in
Depth	54.25 in	54.25 in	54.25 in
Height	45.25 in	45.25 in	47.5 in
Product weight	430 lb	440 lb	610 lb

Standard Control Voltage: 24 VDC Standard motor voltage 460/3/60

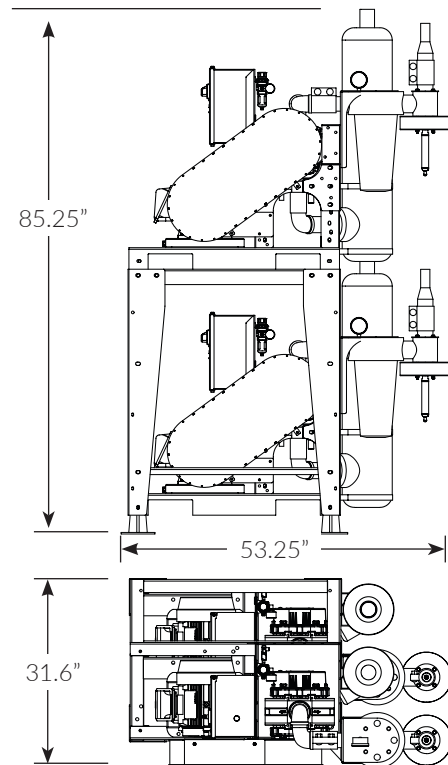

Above dimensions for 3 Hp or 5 Hp pumps stacked 2 - high. Add 2 inches to height for 10 Hp

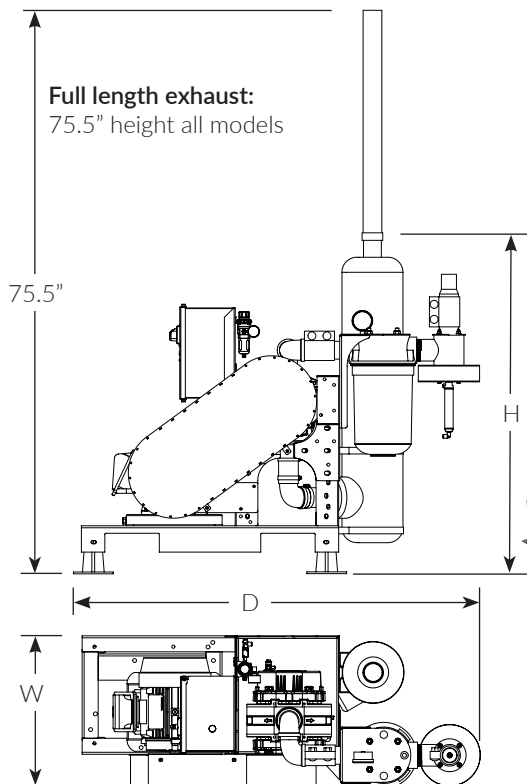

**Options:**

**Alternate Control Voltages:**

115/1/60 VAC (no charge)

**Alternate Power Voltages:**

460/3/60 (standard)

575/3/60 (no charge) - includes fused disconnect with thermal motor overload protection

400/3/50 (no charge)

**DeviceNet Cable(s) for Pump:**

In lieu of standard cable(s) (available in 24 VDC only)

**Accessories:**

**Stacking Stand DeviceNet Cable for DSV:**

(in lieu of standard cables -24VDC only)

**DSV Discharge Selection Valve for Dry Air Conveying:**

EPV valve with connection stub to pump for 115 VAC or 24 VDC for line diameters of 1.5, 2, and 2.5 inches

DSV discharge selection valve

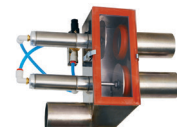

**CLR Closed Loop Valve with Relief Vent:**

Provides pressure relief in a closed loop conveying system for line diameters of 1.5, 2, 2.5 and 3 inches

CLR closed loop valve with relief vent

