



# VR Vacuum Receivers

VR Series Receivers provide transfer of plastic pellets and regrind using centralized vacuum pumps and controls.

Standard models are made for flange mounting to existing bins or hoppers. A vacuum "T" sequencing valve, purchased separately, is required for each receiver when multiples are used in a system. Optional pulsed air blowback package eliminates regrind screen clogging or erratic material discharge.

## Stainless Steel Body

Stainless steel body provides a scratch-resistant, non-ferrous material contact surface.

## Modular Design, Quick-Release Clamps

Easy access for quick cleanout and material changeover – no tools required.

## Material Inlet Deflector Check Valve

Neoprene gasket provides positive seal. No external material line valve needed!

## Tangential Material Inlet

Provides cyclonic air/material separation which minimizes material degradation.

## Dump Valve With Integrated Level Switch

Included on standard and blowback models

— 5 —  
**YEAR**  
warranty



VR-12



VR-38

## Plus

- › Reinforced 20 mesh stainless steel pellet screen
- › Inlet/outlet diameters of 1.5" to 4" (3.8 – 10.16 cm)
- › 24 VDC or 115 VAC control voltage
- › 5-Year warranty

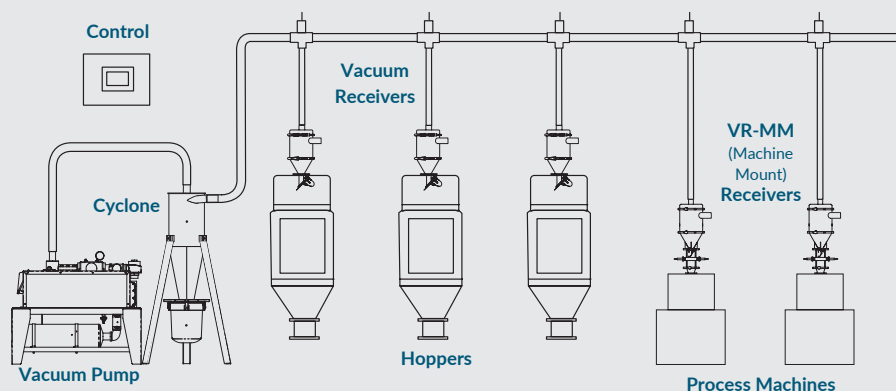

# Many popular features **not** found on other receivers



Heavy duty stainless steel construction. Stainless steel band clamp with safety latch provides easy access (requires no tools).



Custom molded neoprene gasket on full-flow dump throat assures tight seal and no loss of vacuum. Unique design keeps resin from contacting gasket surface.

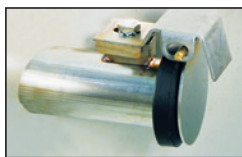

Tangential inlet provides cyclonic flow minimizing material degradation. Internal flapper with neoprene seal allows common line system use.



Expanded aluminum supports 20 mesh stainless steel fines filter screen.



VR-8

VR-12 machine mount with standard 2 lb glass

VR-12 with blowback



2 lb glass hopper adapter



8-16 lb glass hopper adapter

Machine mount models are supplied with a height-adjustable photo eye level sensor, base plate adapter, dump valve and quick disconnect clamps for easy clean out.

## Popular Accessories for Vacuum Receivers

External proportioning valve provides proportioning/layering of materials when used with VR receivers. Optional mini PLC control may be programmed for proportioning. Shipped with coupler. Choose 24VDC or 115 VAC. See separate data sheet.

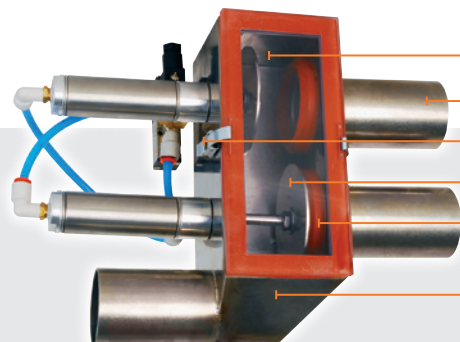

- Polycarbonate access window
- Inlet/outlet diameter 1.5"
- Quick-release latches
- Stainless steel disc/seat
- Molded V-tip ring gaskets are flange mounted - out of material flow
- Stainless steel body with unique design creates turbulent flow to clear material



Vacuum receivers can be mounted on machine hopper assemblies available in multiple sizes. See separate data sheet.

## Specifications

| Model    | Configuration   | Volume          |        | Capacity* |      | Line Size        |                 |
|----------|-----------------|-----------------|--------|-----------|------|------------------|-----------------|
|          |                 | ft <sup>3</sup> | liters | lb        | Kg   | in               | mm              |
| VR-5     | Standard        | 1/25            | 1.1    | 1.5       | 0.7  | 1.5, 2, 2.5      | 38, 50, 64      |
| VR-5-B   | Blowback †      |                 |        |           |      |                  |                 |
| VR-5-MM  | Machine Mount † |                 |        |           |      |                  |                 |
| VR-8     | Standard        | 1/5             | 5.7    | 8         | 3.6  | 1.5, 2, 2.5      | 38, 50, 64      |
| VR-8-B   | Blowback †      |                 |        |           |      |                  |                 |
| VR-8-MM  | Machine Mount † |                 |        |           |      |                  |                 |
| VR-12    | Standard        | 1/3             | 9      | 12        | 5.4  | 1.5, 2, 2.5, 3.0 | 38, 50, 64, 76  |
| VR-12-B  | Blowback †      |                 |        |           |      |                  |                 |
| VR-12-MM | Machine Mount † |                 |        |           |      |                  |                 |
| VR-19    | Standard        | 1/2             | 14     | 19        | 8.6  | 1.5, 2, 2.5, 3.0 | 38, 50, 64, 76  |
| VR-19-B  | Blowback †      |                 |        |           |      |                  |                 |
| VR-19-MM | Machine Mount † |                 |        |           |      |                  |                 |
| VR-38    | Standard        | 1               | 28     | 38        | 17.2 | 1.5, 2, 2.5, 3.0 | 38, 50, 64, 76  |
| VR-38-B  | Blowback †      |                 |        |           |      |                  |                 |
| VR-38-MM | Machine Mount † |                 |        |           |      |                  |                 |
| VR-76    | Standard        | 2               | 56     | 76        | 34.5 | 2, 2.5, 3, 4     | 50, 64, 76, 102 |
| VR-76-B  | Blowback †      |                 |        |           |      |                  |                 |
| VR-114   | Standard        | 3               | 84     | 114       | 51.7 | 2, 2.5, 3, 4     | 50, 64, 76, 102 |
| VR-114-B | Blowback †      |                 |        |           |      |                  |                 |

\* Resin capacity based on 38 lb/ft<sup>3</sup> bulk density.

† 24VDC standard – 115V is a no charge option.

## Accessories:

### Pulsed Blowback Control:

Mini-PLC control mounts near receiver and generates adjustable blowback signals when the central control is not equipped with the blowback feature.

### External Proportioning Valve with Coupler:

Available for all receivers. (See separate data sheet)

### Proportioning Valve Control:

Mini-PLC control mounts near receiver and generates adjustable proportioning signals when the central control is not equipped with proportioning capability. Utilizes the receiver's load signal.



### Retrofit Glass Hopper Sizes for Existing MM Units:

(In lieu of 2 lb) Field conversion kit includes base, glass, top adapter plate and discharge valve. 8, 12, or 16 lb glass.

### Station "T" Sequencing Valve:

Required for all receivers. (See separate data sheet)

### Level Switch, Capacitance:

30mm diameter, 2m cable - Available for all receivers.

## Options:

### Must Specify JIT Glass Hopper Size – MM Units

2 lb standard on -8-MM, -12-MM and -19-MM

(8,12, and 16 lb optional)

16 lb standard on VRH-38-MM (8 and 12 lb optional)

Note: 2 lb glass not available on VRH-38

### DeviceNet Cables for All Models:

(in lieu of standard cables, 24VDC only)

### High Heat Packages for Discharge, Filter Assemblies and Inlet Check Valve:

(For temps above 250°F) (See price list 315)

### Custom Drilling of MM Flange:

(Standard base flange is blank for customer drilling.)

### Extended Wear Package for VR-5, through VR-114 Models Includes:

- Removable ceramic lined inlet (N/A on VR-5 and VR-8)
- Ceramic coated inlet flapper check valve
- Removable ceramic coated impact wear plate
- SS Discharge flapper

### Ceramic lined inlet diameters available

- VR-5, VR-12 and VR-19 (1.5" - 2.5")
- VR-38 and VR-76 (1.5" - 3")
- VR-114 (2.5" - 4")

(See price list 315)

## Dimensions and Weights

| Hopper Loading Packages |    |     |    |    |      |      |    |      |               |    |
|-------------------------|----|-----|----|----|------|------|----|------|---------------|----|
| Part Number             | A  |     | B  |    | C    |      | D  |      | Shipping Wgt. |    |
|                         | in | cm  | in | cm | in   | cm   | in | cm   | lb            | Kg |
| VR-5                    | 18 | 46  | 11 | 27 | 4.3  | 11   | 6  | 15.2 | 25            | 11 |
| VR-8                    | 29 | 74  | 22 | 55 | 13.2 | 33.5 | 6  | 15.2 | 29            | 13 |
| VR-12                   | 24 | 62  | 18 | 45 | 10.6 | 22   | 10 | 25   | 40            | 18 |
| VR-19                   | 28 | 72  | 22 | 55 | 14.6 | 37   | 10 | 25   | 45            | 21 |
| VR-38                   | 34 | 86  | 25 | 63 | 17.7 | 45   | 16 | 41   | 55            | 25 |
| VR-76                   | 43 | 109 | 35 | 88 | 27   | 69   | 16 | 41   | 65            | 30 |
| VR-114                  | 42 | 107 | 34 | 87 | 25   | 64   | 24 | 61   | 120           | 55 |

### Mounting Patterns

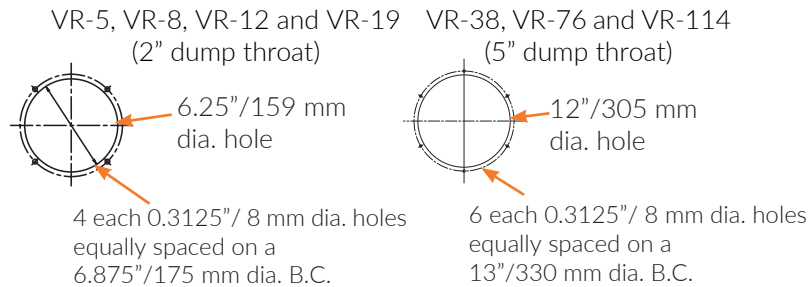

| Machine Mount Packages (2 lb Glass) |      |      |      |      |    |      |               |    |
|-------------------------------------|------|------|------|------|----|------|---------------|----|
| Part Number                         | A    |      | B    |      | D  |      | Shipping Wgt. |    |
|                                     | in   | cm   | in   | cm   | in | cm   | lb            | Kg |
| VR-5 MM                             | 22   | 56   | 15.6 | 39.6 | 6  | 15.2 | 30            | 14 |
| VR-8 MM                             | 33   | 84   | 24.5 | 62   | 6  | 15.2 | 34            | 16 |
| VR-12 MM                            | 28.6 | 72.6 | 22   | 56   | 10 | 25   | 45            | 21 |
| VR-19 MM                            | 32.6 | 82.8 | 26   | 66   | 10 | 25   | 50            | 23 |
| VR-38-MM                            | 37.9 | 92.3 | 30.7 | 78   | 16 | 4.6  | 60            | 28 |

NOTE: 8 lb glass: add 3.7" to A and B, 12 lb glass: add 7.7" to A and B, 16 lb glass: add 10.7" to A and B. (2 lb glass n/a on VR-38)  
(See options page 3)

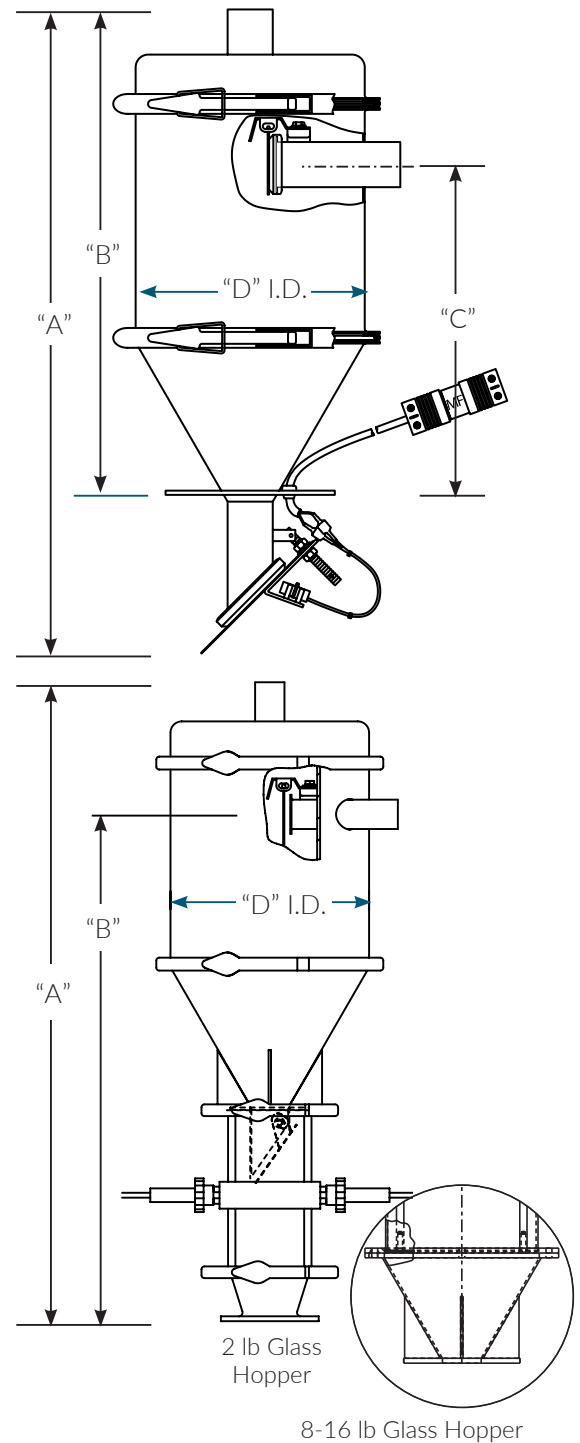
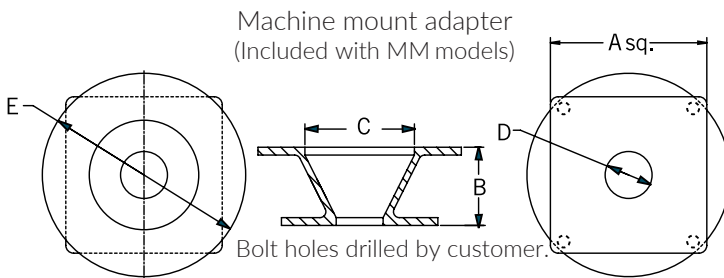

| Machine Mount Adapter Dimensions |                     |     |      |     |      |     |      |      |     |     |      |
|----------------------------------|---------------------|-----|------|-----|------|-----|------|------|-----|-----|------|
| Glass Size<br>lb/Kg              | Model               | A   |      | B   |      | C   |      | D    |     | E   |      |
|                                  |                     | in  | cm   | in  | cm   | in  | cm   | in   | cm  | in  | cm   |
| 2/0.9                            | VR-5, -8, -12, -19  | 5   | 12.7 | 2.5 | 6.4  | 3.5 | 8.9  | 1.5  | 3.8 | 6.5 | 16.5 |
| 2/0.9                            | VR-MM-F65*          | 6.5 | 16.5 | 2.5 | 6.4  | 3.5 | 8.9  | 2.25 | 5.7 | 6.5 | 16.5 |
| Varies                           | VR-MM-8, -12, -16** | 6   | 15.2 | 5.7 | 14.5 | 8   | 20.3 | 2    | 5.1 | 10  | 29.2 |

\* Optional 2 lb glass adapter dimensions

\*\* Optional large glass adapter dimensions

Baltimore, MD 21225 USA 410-789-4811 | Fax: 410-789-4638 | 1-800-BESTDRY (800-237-8379) | sales@novatec.com | www.novatec.com