



VL Vacuum Loaders

Reduce labor and resin waste with self-contained, ready-to-install loading systems for pellets and regrind.

VL Series loaders provide self-contained, vacuum transfer of plastic pellets and regrind over short distances using powerful single-phase vacuum motors. Standard models are made for flange mounting to existing bins or hoppers.



Model
VL-12

› **Stainless Steel Body**

Provides a rugged, non-ferrous material contact surface.

› **Remote-Mount, Mini-PLC Control**

Supplied with 10 feet (3 meters) of remote mount cable.

› **“No-Load” Alarm and Silencer Button**

Identifies empty loaders more quickly.

› **Easy Access Modular Design**

For quick cleanout and material changeover.

› **Automatic, Pulsed Blowback Filter Cleaning with Accumulator**

Powerful blowback reduces frequency of manual filter cleaning.

› **Machine Mount Configurations**

Includes a glass material storage tube (customer specified capacity) with integrated vacuum flapper and photo-eye sensor.

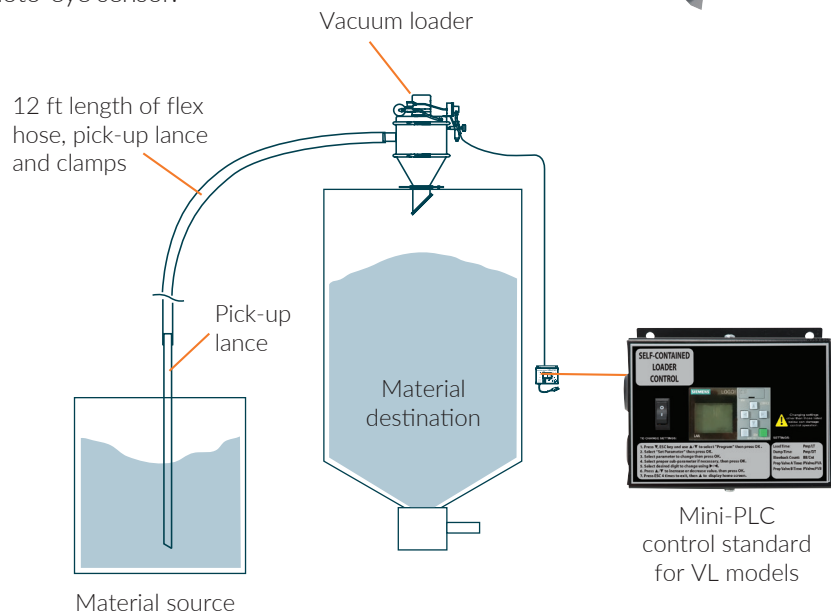

Plus

- › 115 V/1 ph/50-60 Hz (220 V/1 ph/50-60 Hz optional)
- › 12 ft (3.66 meters) length of flex hose, pickup wand and hose clamps
- › Reinforced polyester disc filter media
- › Dump valve with integrated demand level switch on standard models
- › Five-year warranty (excludes motor, brushes and filter)

Many premium features not found on other loaders

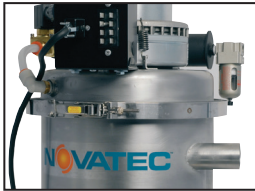

Heavy-duty, stainless steel construction. Band clamp with safety latch provides no-tools, easy access.

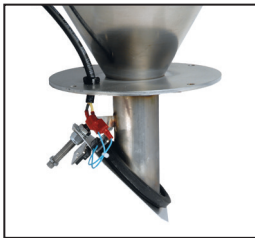

Custom molded neoprene gasket on full-flow dump throat assures tight seal and no loss of vacuum. Unique design keeps resin from contacting gasket surface.

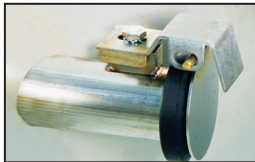

Internal material deflector/flapper check valve with seal ensures that blowback does not travel down the material line.



Expanded aluminum support extends life of durable polyester fines-filter.

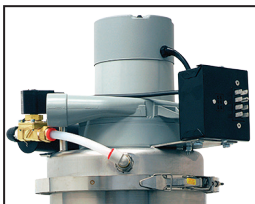

Brushless motor option available on VL-12 through VL-38.

Machine-mount models are supplied with a height-adjustable photo-eye level sensor, base plate adapter, dump valve and quick-disconnect clamps for easy clean out.

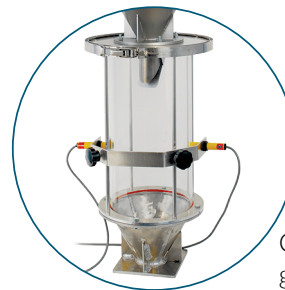

VL-5-MM

Customer specified glass hopper size, 2 - 16 pound capacity.

Popular Accessories for Vacuum Loaders

External proportioning valve provides proportioning/layering of materials for VL Loaders when used with mini-PLC control. See separate data sheet.

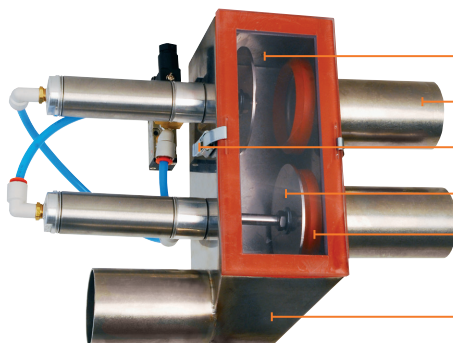

- Polycarbonate access window
- Inlet/outlet diameter 1.5-inch
- Quick-release latches
- Stainless steel disc/seal
- Molded V-tip ring gaskets are flange mounted - out of material flow
- Stainless steel body with unique design creates turbulent flow to clear material



Vacuum loaders can be mounted on machine hopper assemblies available in multiple sizes.

Mini-PLC control controls all loading functions



No-load alarm horn and silencer button

**No-Load
Alarm
Standard!**

- › This 115 VAC plug and play control can be conveniently located at operator level. (220/1/50 VAC optional)
- › Selection, programming and editing of loader parameters are accomplished through a user-friendly interface.
- › The graphic faceplate displays parameter, value codes and provides step-by-step programming instructions.
- › The control receives a load-initiating signal from a dump throat mounted demand switch.
- › Control can be programmed to convey one material up to 99 seconds, or proportion two materials in multiple layers when used with an external proportioning valve.

Inlet diameter: 1.5-inch (40 mm) OD
Pulse duration: 500 milliseconds
Total pulses: Adjustable
Air service: 80 PSI (5.5 bars) required

SPECIFICATIONS

Model	VL-5 / VL-5-MM		VL-12 / VL-12-MM		VL-19 / VL-19-MM		VL-38 / VL-38-MM	
Characteristic	Imperial/USA	Metric	Imperial/USA	Metric	Imperial/USA	Metric	Imperial/USA	Metric
Volume	1/25 ft³	1.1 liters	1/3 ft³	9 liters	1/2 ft³	14 liters	1.0 ft³	28 liters
*Resin Capacity	1.5 lb	0.7 kg	12 lb	6 kg	19 lb	9 kg	38 lb	17 kg
Inlet/Dump Throat OD	1.5/2 in	40/50 mm	1.5/2 in	40/50 mm	1.5/2 in	40/50 mm	1.5/5 in	40/127 mm
**Recommended Throughput / hr (brush type motor)	200 lb	91 kg	400 lb	181 kg	500 lb	227 Kg	650 lb	295 kg
**Recommended-Throughput / hr (brushless motor)	N/A	N/A	650 lb	295 kg	1000 lb	454 Kg	1200 lb	544 kg
Load time (seconds)	up to 99		up to 99		up to 99		up to 99	
Dump time (seconds)	up to 99		up to 99		up to 99		up to 99	
Amps @115V	8		13		13		13	
Compressed air usage	0.2 ft³/min (5.66 liters/min)							

* Resin capacity and throughput based on 38 lb/ft³ bulk density. Adding external proportioning valve reduces throughput.

** Recommended throughput/hr based on free flowing virgin pellets through 15 feet of flex hose. Exceeding recommended throughputs may result in shortened brush and filter life however, increased throughputs are possible depending on resin and equivalent feet calculation. Generally, a central conveying system should be used for higher throughputs.

Maximum conveying distance in addition to 15 feet of flex hose, can include 30 feet of horizontal tubing and one elbow. Additional vertical travel, bends or flex hose will reduce recommended throughput.

SPECIFICATIONS

Standard Dump Throat Models										
Model	A		B		C		D		Shipping Weight	
	in	cm	in	cm	in	cm	in	cm	lb	kg
VL-5	23	58	17	43	5	13	6	15	50	23
VL-12	28	71	22	56	11	28	10	25	60	27
VL-19	32	81	26	66	15	38	10	25	70	32
VL-38	38	97	29	74	17	43	16	41	80	36

Machine Mount Model Dimensions

Must specify glass hopper size for all models.

*2 lb glass: add 3 in. to "A" above (no charge)

8 lb glass: add 3.7 in. to "A" above

12 lb glass: add 7.7 in. to "A" above

16 lb glass: add 10.7 in. to "A" above

*VL-5-MM available with 2 lb glass only

ACCESSORIES

- › **External Proportioning Valve**
1.5-inch OD (3.6 cm) with coupler, wand, hose and clamps.
- › **Remote Demand Sensor for Grinder Drawer 115 VAC**
Sends demand when covered.
- › **Field Conversion Kit for existing - MM models**
Includes base, glass, top adapter plate and discharge valve. 8 lb, 12 lb and 16 lb glass
- › **Brushless Motor Retrofit Kit**
For VL-12 through VL-38 models (for 115 VAC only)
(Replaces existing brush and brushless motors)
Includes motor, lid and modified J-box with relay.



Brushless Motor Retrofit Kit

OPTIONS

- › **Alternate Voltages**
220/1/50-60 in lieu of 115/1/50-60
- › **Must Specify Glass Hopper Size for All -MM Models**
For VL-5-MM: 2 lb glass only (no charge).
For VL-12-MM:- through VL-38-MM: 2, 8, 12 or 16 lb glass.
- › **Brushless Motor**
Add -BR to VL model number for VL-12 through VL-38.
Brushless motor adds 2 inches to overall height.
- › **Custom Drilling of MM Flange**
Standard base flange is blank for customer drilling.
- › **Extended Wear Package**
Recommended when loading abrasive materials - contact factory.

Machine Mount Adapter Dimensions											
Model	Glass Size lb/kg	A		B		C		D		E	
		in	cm	in	cm	in	cm	in	cm	in	cm
VL-(5,12, 19 & 38)-MM	2/0.9	5	12.7	2.5	6.4	3.5	8.9	1.5	3.8	6.5	16.5
opt-MM-F65**	2/0.9	6.5	16.5	2.5	6.35	3.5	8.9	2.25	5.7	6.5	16.5
opt-MM-8, -12, -16***	Varies	6	15.2	5.7	14.5	8	20.3	2	5.1	10	25.4

** Optional 2 lb glass adapter dimensions

*** Optional large glass adapter dimensions

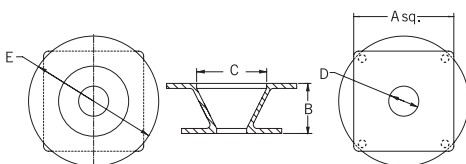

Machine Mount Adapter
(Included with MM models)

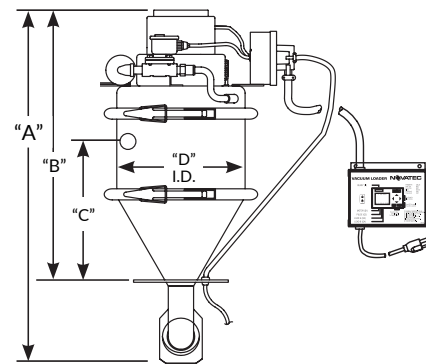

Mounting Patterns

VL-5, VL-12, VL-19 (2-inch dump throat)

VL-38 (5-inch dump throat)

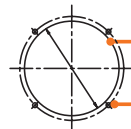

6.25 in./159 mm dia. hole

4 each 0.3125 in./8 mm dia. holes equally spaced on a 6.875 in./175 mm dia. B.C.

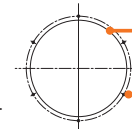

12 in./305 mm dia. hole

6 each 0.3125 in./8 mm dia. holes equally spaced on a 13 in./330 mm dia. B.C.